

KMR D Series

Momentary Detect Switches



Specifications

Function	Momentary action
Contact Arrangement	1 make contact = SPST, N.O.
Terminals	Gullwing type for SMT

Mechanical Characteristics

Type	Fce Forward (N)	Fce Return	Travel (mm)	Operating Life
KMR401G LFS	$0.35 \leq F_{ce} \leq 1.85N$	$0.15 \leq F_{ce} \leq 1.65N$	0.225 ± 0.175	100,000

Electrical Characteristics

Maximum Power	1 VA
Maximum Voltage	32 VDC
Minimum Voltage	20 mVDC
Maximum Current	50 mA
Minimum Current	1 mA
Dielectric Strength	$\geq 250 V_{rms}$
Contact Resistance	$\leq 100m\Omega$
Insulation Resistance	$\geq 1 G\Omega$
Bounce Time	$\leq 3 ms$

Environmental

Operating Temperature	-40°C to 85°C
Storage Temperature	-55°C to 85°C

Process

Soldering	Lead free reflow soldering process in accordance with IEC 61760-1.
Packaging	In reels of 6,000 pieces. External diameter 330 mm \pm 2mm

Notes:

Specifications listed above are for switches with standard options. For information on specific and custom switches, consult Customer Service Center.

Description

KMR D series is microminiature SMT top actuated detect switch. KMR D detect is an ultra-miniature detector switch with single normally open contact. The switch is ideal for IoT, consumer electronics and bluetooth devices.

Features & Benefits

- Ground pin
- Height 2.5 mm
- Compact size 4.6 x 2.8
- Momentary detect
- IP40

Applications

- IoT
- Consumer electronics
- Bluetooth headset

KMR D Series

Momentary Detect Switches



Ordering Number

To order, simply select desired option from each category and place in the appropriate box. Available options are shown and described on the next page. For additional options not shown in catalog, consult Customer Service Center.

KMR - 4 - 0 - 1 - xx - xxx - LFS

Total Height
4: 2.5 mm

Contact Material
1: Silver

Low Current Capability
Void: Under standard specification

Grounding Option
G: Ground pin
NG: No Ground Pin¹

Notes:

1. On request

G - Ground Pin

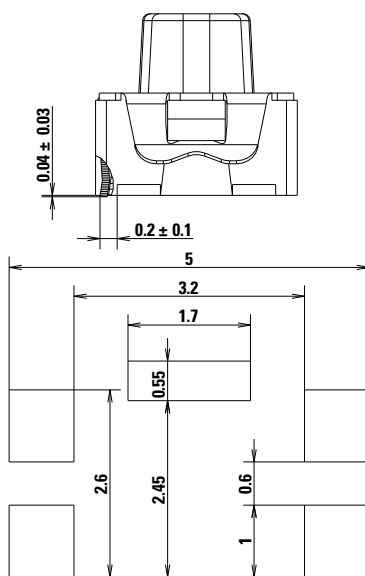
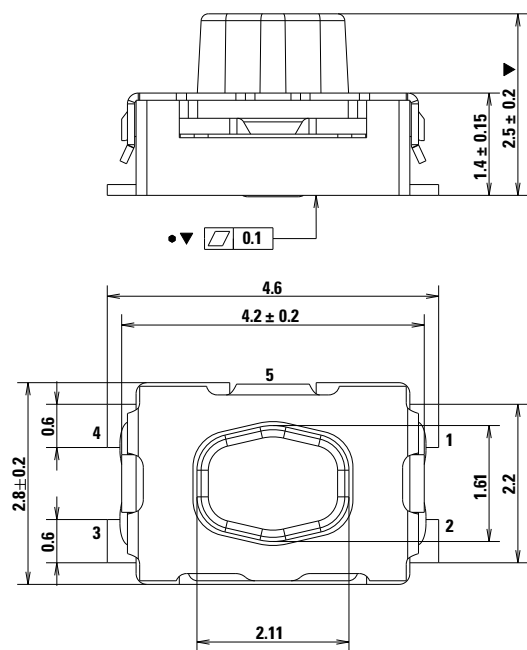

RECOMMENDED LAYOUT

ELECTRICAL DIAGRAM

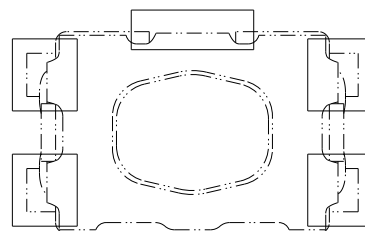
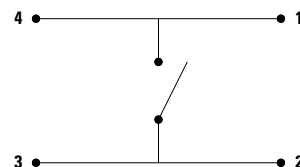

KMR D Series

Momentary Detect Switches



NG - No Ground Pin

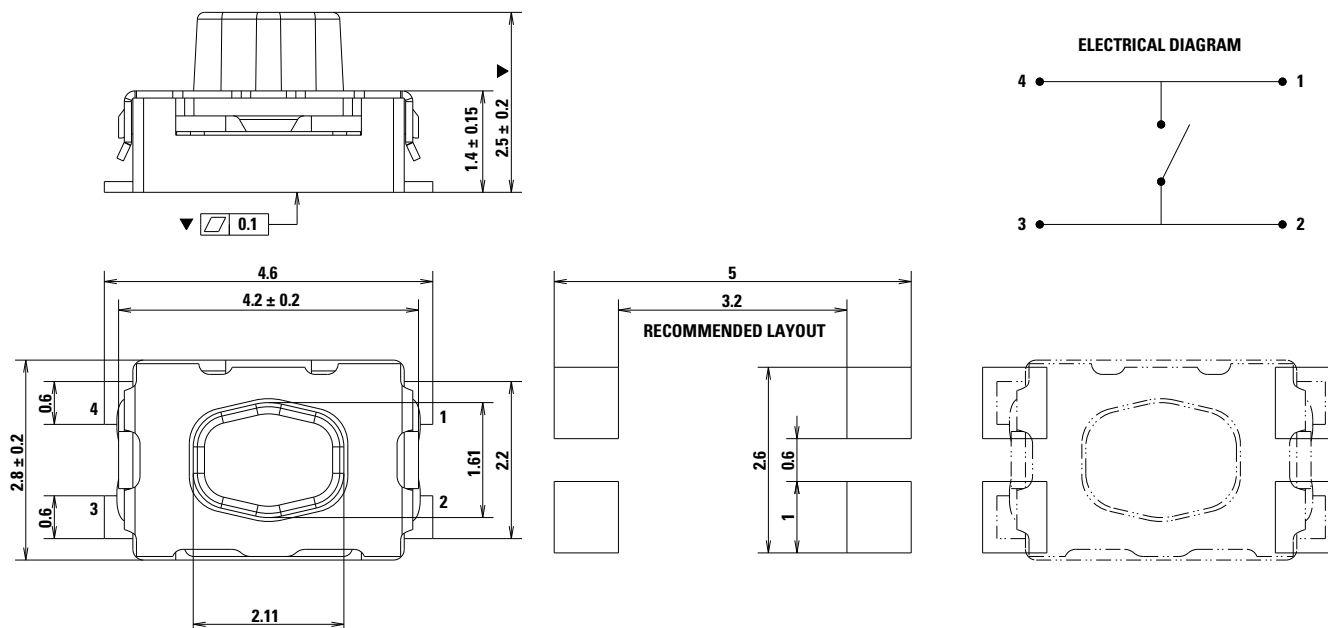

Tape & Reel

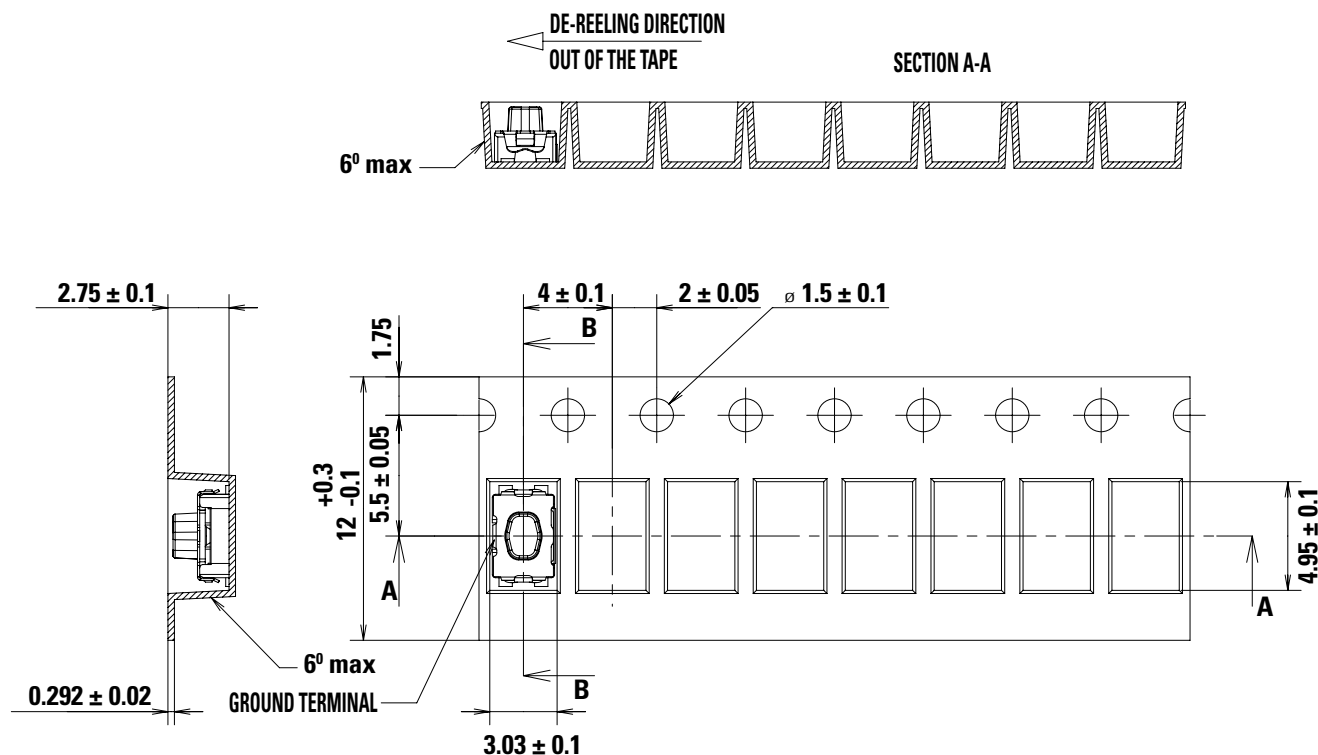

Disclaimer Notice - Information furnished is believed to be accurate and reliable. However, users should independently evaluate the suitability of and test each product selected for their own applications. Littelfuse products are not designed for, and may not be used in, all applications. Read complete Disclaimer Notice at <http://www.littelfuse.com/disclaimer-electronics>.