

# KDS Series

## Intrusion Switches

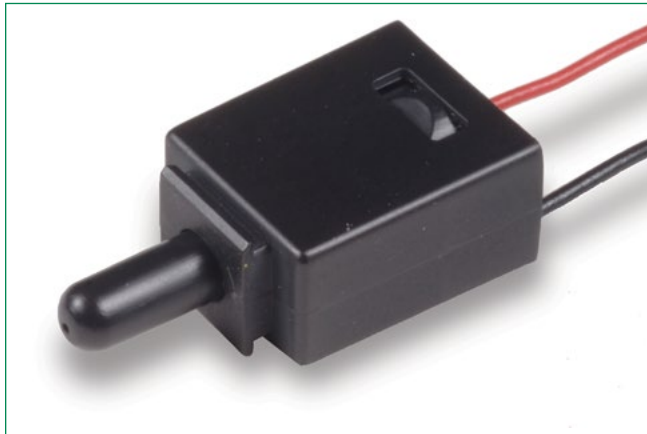

### Specifications

|                                   |  |
|-----------------------------------|--|
| <b>Contact Rating</b>             | 0.4 VA max. @ 20 VAC or DC   |
| <b>Mechanical/Electrical Life</b> | 10,000 actuations min. at full load  |
| <b>Contact Resistance</b>         | 200 m $\Omega$ max. initial @ 2-4 V DC, 100 mA   |
| <b>Insulation Resistance</b>      | 10 <sup>9</sup> $\Omega$ min.  |
| <b>Operating Temperature</b>      | -40°C to 85°C  |
| <b>Travel</b>                     | KDS11: Travel to make from 1.9 mm to 5.9 mm <sup>1</sup><br>KDS33: No pre-travel, full travel 0.403" |
| <b>Dielectric Strength</b>        | 500 Vrms min. @ sea level  |
| <b>Packaging</b>                  | Bulk packaging   |

### Description

KDS series intrusion switches are used to power intrusion/alarm switches in network desktop PCs, in cellular base stations and in telecommunications equipment. C&K's KDS series are RoHS compliant, available in either N.O. or N.C. configurations and have an easily customizable wire harness length and connector. In addition, these switches are designed to slot mount directly into the chassis, helping to reduce installation costs.

### Features & Benefits

- Slot mount into chassis to reduce installation cost
- Wire harness length & connector easily customized
- Available in N.O. or N.C. configuration
- RoHS compliant

### Applications

- Intrusion/Alarm switch in network desktop PC
- Intrusion/Alarm switch in telecommunication equipment
- Intrusion/Alarm switch in cellular base station

### Materials

|                         |  |
|-------------------------|--|
| <b>Housing/Actuator</b> | Nylon 6/6 (UL 94V-0)                       |
| <b>Movable Contact</b>  | Copper alloy, gold plate over nickel plate |
| <b>Fixed Contact</b>    | Brass, gold plate over nickel plate        |
| <b>Wire</b>             | UL 1061-24 AWG                             |

#### Notes

1. Specifications and materials listed above are for switches with standard options. For information on specific and custom switches, consult Customer Service Center.

### Ordering Number



Part number list is shown below. For individual part details, please refer to the following pages.

| Part Number (Part Description) | Product Details                   |
|--------------------------------|-----------------------------------|
| KDS11                          | Intrusion switches normally open  |
| KDS33                          | Intrusion switches normally close |

# KDS Series

## Intrusion Switches

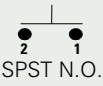

| Part Number | Switch Function |        | Schematic   |
|-------------|-----------------|--------|---|
|             | POS. 1          | POS. 2 |   |
| KDS11       | OFF             | MOM.   |  |
| KDS33       | ON              | OFF    |  |

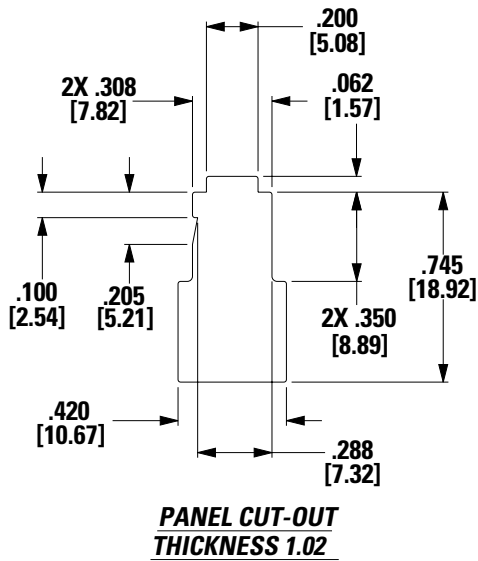

### KDS33

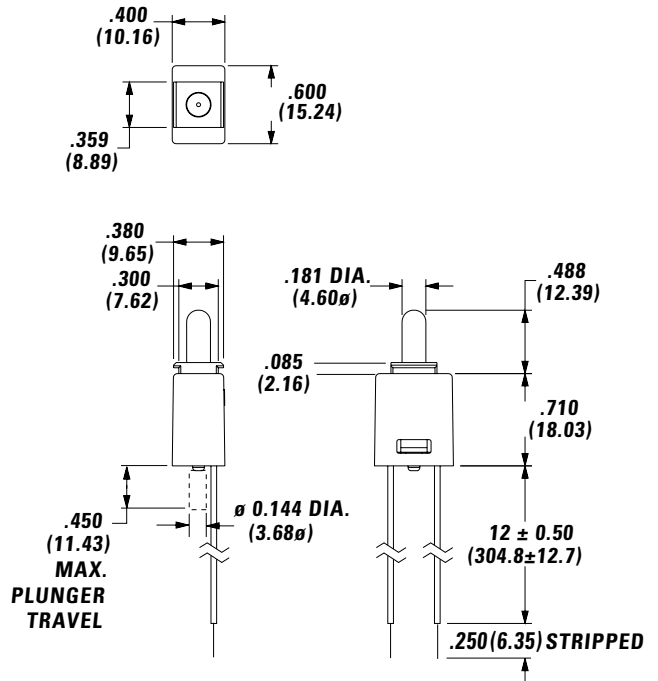
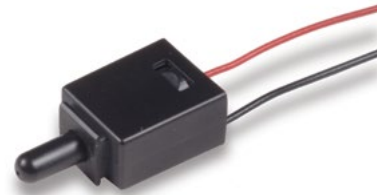

**Disclaimer Notice** - Information furnished is believed to be accurate and reliable. However, users should independently evaluate the suitability of and test each product selected for their own applications. Littelfuse products are not designed for, and may not be used in, all applications. Read complete Disclaimer Notice at <http://www.littelfuse.com/disclaimer-electronics>.